

1663 Avex

Dome head · Aluminium body · Stainless steel stem · Multi-grip
3.0 mm (.118") - 4.8 mm (3/16")

Features

- Multi-grip capability accommodates wide variations in material thickness
- Good hole fill provides strong, vibration resistant joints
- Compensates for irregular, oversized, slotted or misaligned holes
- Can stop sheet movement in non-standard holes
- Retained stem avoids damage, electrical problems or rattling caused by loose stems
- Provides a large blind side bearing area against the rear sheet
- Spreads the tail bearing load/clamp load on the rear sheet making it ideal for use in thin sheet materials

Material

- Body: Aluminium alloy (2.5% Mg) AA5052, natural
- Stem: Stainless steel, natural

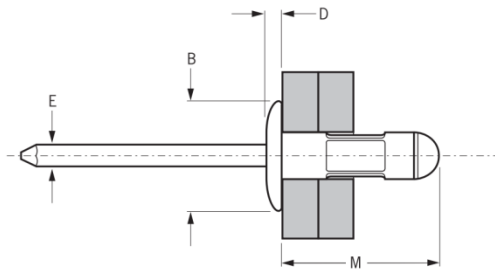

Before Placement

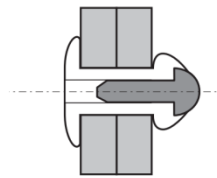

After Placement

Part No.	Size ø	Grip Range		Hole Size		M	øB	D	øE	Shear (typical) kN	Tension (typical) kN
		min.	max.	min.	max.						
01663-05307	3.0 (.118")	0.8	4.3	3.1	3.3	9.1	6.7	1.3	1.7	0.70	0.98
01663-00410	3.2 (1/8")	0.8	4.8	3.3	3.4	10.4	6.7	1.3	1.8	0.73	1.02
01663-00412		1.2	6.3			12.0					
01663-00414		4.0	7.9			13.6					
01663-00416		5.5	9.5			16.0					
01663-00508	4.0 (5/32")	0.5	3.2	4.1	4.2	9.3	8.2	1.6	2.2	1.13	1.67
01663-00510		0.8	4.7			10.7					
01663-00512		1.2	6.3			12.5					
01663-00516		4.0	9.5			16.2					
01663-00521		6.4	12.7			19.6					
01663-00613	4.8 (3/16")	1.6	6.3	4.9	5.0	13.9	10.1	1.8	2.9	1.53	2.33
01663-00619		4.8	11.1			18.7					
01663-00621		4.8	12.7			20.2					
01663-00631		12.7	19.8			28.2					